

MALDIVES LEGEND II

maldivescollections.com/maldiveslegend

 **Length:** 36 m

 **Cabins:** 12

 **Pax:** 24

 **Speed:** 14 kn

CABINS



03 Seaview Suites & 1 Seaview Cabin



08 Standard Cabins

Maldives Legend II can accommodate a maximum of 24 guests in 12 cabins. All Cabins are equipped with airconditioned and hot and cold shower. All Seaview Suites have minibar and hairdryer available. There are a total of 3 seaview suites and 1 seaview cabin on the upper deck. All Seaview suites are equipped with king sized beds and two of them can be converted to a twin cabin. The seaview standard cabin has a bunk bed cabin. All Standard Cabins are on the lower deck. 2 of the seaview cabins are double bed cabins. 1 Seaview Cabin is equipped with a king sized bed. 5 Seaview Cabins have twin accommodation with 2 single beds.



SPECIFICATIONS

Vessel:	Wooden Hull (Tholan Timber with upper water linefully laminated with polished fiberglass)
Year Built:	2009 / Refurbished: 2019
Propulsion:	Main: Cummins 600 HP
Fuel Capacity:	7000 litres
Desalinator:	6000 litres of fresh water per day
Navigation & Communication:	36 miles marine radar system, Eco sounder, Compass, map, fish finder, GPS, CB Radio, mobile phones, internet, search light, binoculars, IDD Telephone
Power:	24hrs 220 volt/ 50 Hz A/C Multiple

UPPER DECK

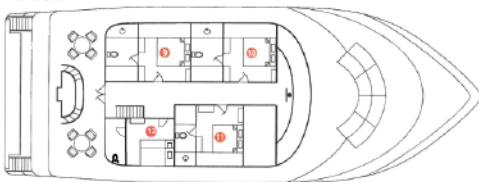

MAIN DECK

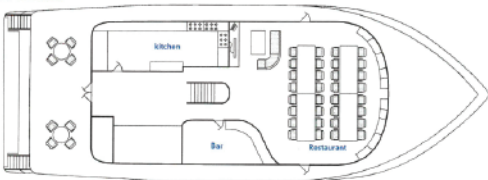

LOWER DECK



FACILITIES



The dining room in the main deck is air conditioned with a cozy bar offering a range of drinks including, beer wine and imported liquors. Our Kitchen provides a variety of Asian, European, Maldivian and Japanese cuisine. Three meals a day will be served including tea and coffee. The sun deck is equipped with jacuzzi and comfortable sun lounges. Both the exteriors on the front and the back of the main deck are equipped with comfortable and luxurious sofas and seatings